

RURAL MUNICIPALITY OF MORRIS

BY-LAW NO. 1203A/82

BEING a By-law of the Rural Municipality of
Morris to amend the Morris Planning Scheme 1968.

WHEREAS the Council of the Rural Municipality of Morris wishes to
amend the Morris Planning Scheme 1968;

AND WHEREAS Section 95(2) of The Planning Act provides that a
planning scheme may be amended;

AND WHEREAS Council deems it expedient and advisable to amend the
Morris Planning Scheme 1968;

NOW THEREFORE, the Council of the Rural Municipality of Morris in
meeting duly assembled, enacts as follows:

1. That the lands described as follows:

All that portion of part of Lot D, with the exception of the
West 140 feet of the South 75 feet and with the exception of the
East 262 feet of the North 133 feet, in Plan 916 in Sperling,
Manitoba of the Morden Land Titles Office;

which parcel is shown by diagonal lines and which is currently
zoned as "GC" General Commercial District be hereby now zoned to
that of "RA" Suburban District and which is shown on Schedule "A"
to this By-law.

2. That Appendix "C" establishing District Map Five attached to and
forming part of the Morris Planning Scheme 1971B and being part
of the Morris Planning Scheme 1968 is hereby amended in accordance
to this By-law.

3. That the Reeve and the Secretary-Treasurer be and they are hereby
authorized to do all things necessary to give force and effect to
this By-law.

DONE AND PASSED in open Council of the Rural Municipality of Morris duly
assembled this 25th day of March, A.D. 1982.

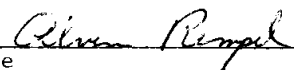
Reeve



Secretary-Treasurer.

Read a first time on the 24th day of February, A.D. 1982.
Read a second time on the 25th day of March, A.D. 1982.
Read a third time on the 25th day of March, A.D. 1982.

STATION

120' GROUNDS

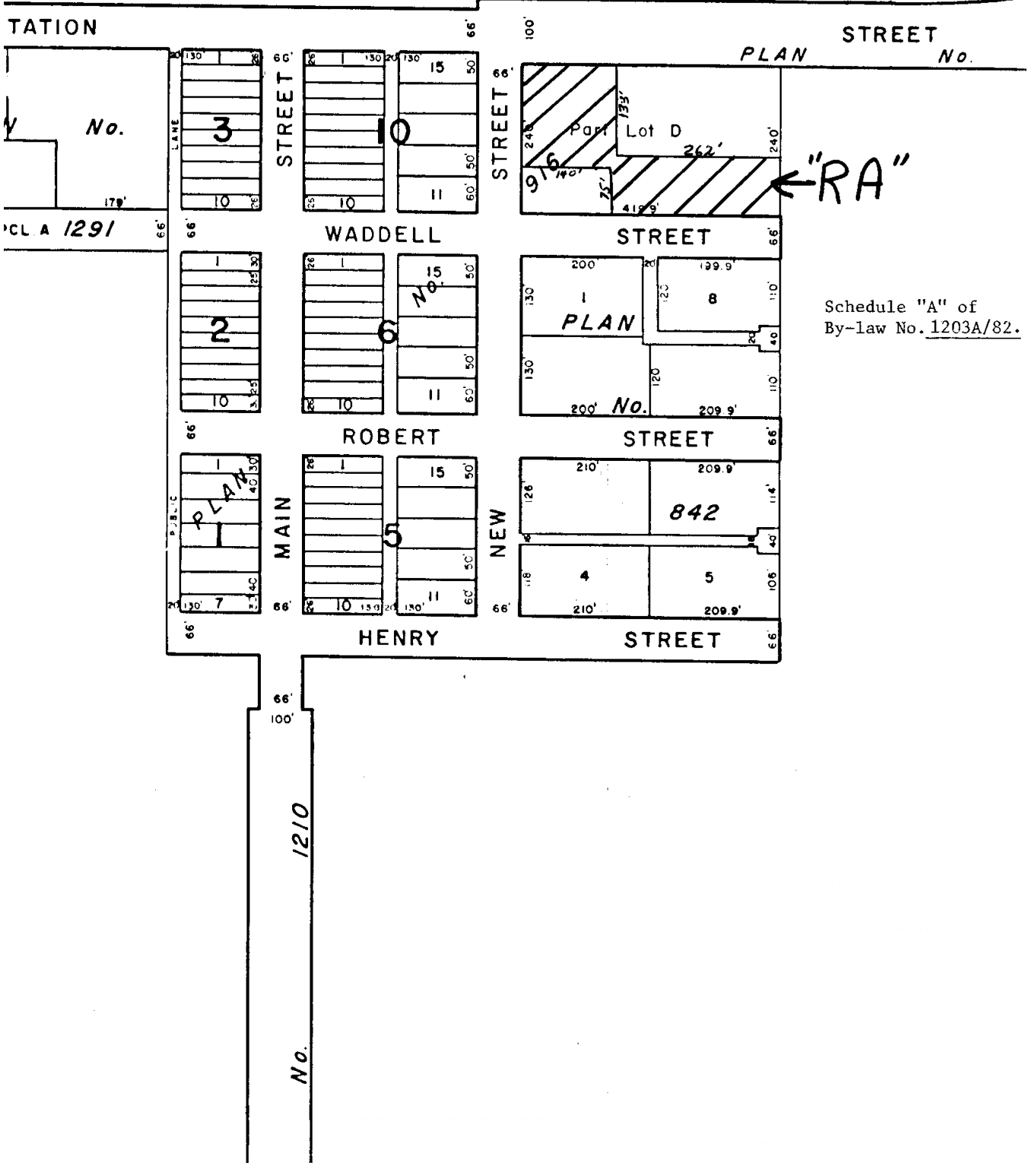
158'



Schedule "A" of By-law No. 1203A/82.