

BY-LAW NO. 1214/82

BEING A By-Law of The Rural Municipality of Morris relative to the closing of a highway and the sale thereof.

WHEREAS The Municipal Act, Sections 209(1)(c) and (d), of the Continuing Consolidation of Manitoba Statutes, Cap. M225, and amendments thereto, provides as follows:

"209 (1) Subject to subsections (2) and (3), the Council of a municipality may pass by-laws:
(c) for closing any highway; . . .
(d) for selling and conveying to any person . . . the title to the land upon which is situated any highway that has been closed;"

AND WHEREAS Sections 209(2)(a) and (b) of The Municipal Act provide as follows:

"209 (2) Before passing a by-law under clause (c) or (d) of subsection (1);
(a) a notice of the proposed by-law shall be published at least once a week for four successive weeks, and a similar notice shall be posted up for at least one month in at least four of the most public places in the immediate neighborhood of the highway; and
(b) the council shall hear in person, or by agent, any person who claims that his land will be prejudicially affected by the by-law and who applies to be heard";

AND WHEREAS a Notice of this by-law has been published at least once a week for four successive weeks in The Scratching River Post, a newspaper having a circulation throughout The Rural Municipality of Morris, in which the highway to be closed is situated;

AND WHEREAS a Notice of this by-law has been posted up for at least one month in four of the most public places in the immediate neighborhood of the highway to be closed;

AND WHEREAS no person has applied to be heard by council of The Rural Municipality of Morris, claiming that his lands would be prejudicially affected by passage of this by-law;

AND WHEREAS the council of The Rural Municipality of Morris deems it necessary and advisable to close the highway hereinafter described, and to transfer and convey same, except mines and minerals to Lowe Farm Housing Crpn. Inc.;

THEREFORE NOW BE IT AND IT IS HEREBY ENACTED as a By-Law of The Rural Municipality of Morris, in Council duly assembled, as follows:

1. THAT the highway in The Rural Municipality of Morris, in Manitoba, legally described as follows:

"All that portion of the South-West Quarter of Section Six in the Fifth Township and First Range, West of the Principal Meridian, in Manitoba, shown as a Public Lane in Block Two, which lies to the North of a straight line drawn from the South-East corner of Lot Fourteen to the South-West corner of Lot Twenty-one in said Block Two, which Lots and Block are shown on a plan registered in the Morden Land Titles Office as No. 522"

be and the same is hereby closed.

2. THAT the highway so closed, except mines and minerals, be transferred and conveyed to LOWE FARM HOUSING CORP. INC., at and for the price and sum of One Dollar and other good and valuable consideration.

3. THAT the Reeve or the Deputy Reeve and the Secretary-Treasurer or the Assistant Secretary-Treasurer be and they are hereby authorized and empowered to execute all documents and to do all things necessary and required to give force and effect to this by-law.

4. THAT this by-law shall come into force on the date it receives the approval of the Minister of Municipal Affairs.

ENACTED at the Town of Morris, in Manitoba, this 10th day of June, A.D. 1982.

THE RURAL MUNICIPALITY OF MORRIS

Per: Alvin Rempel
Reeve

Per: [Signature]
Secretary-Treasurer

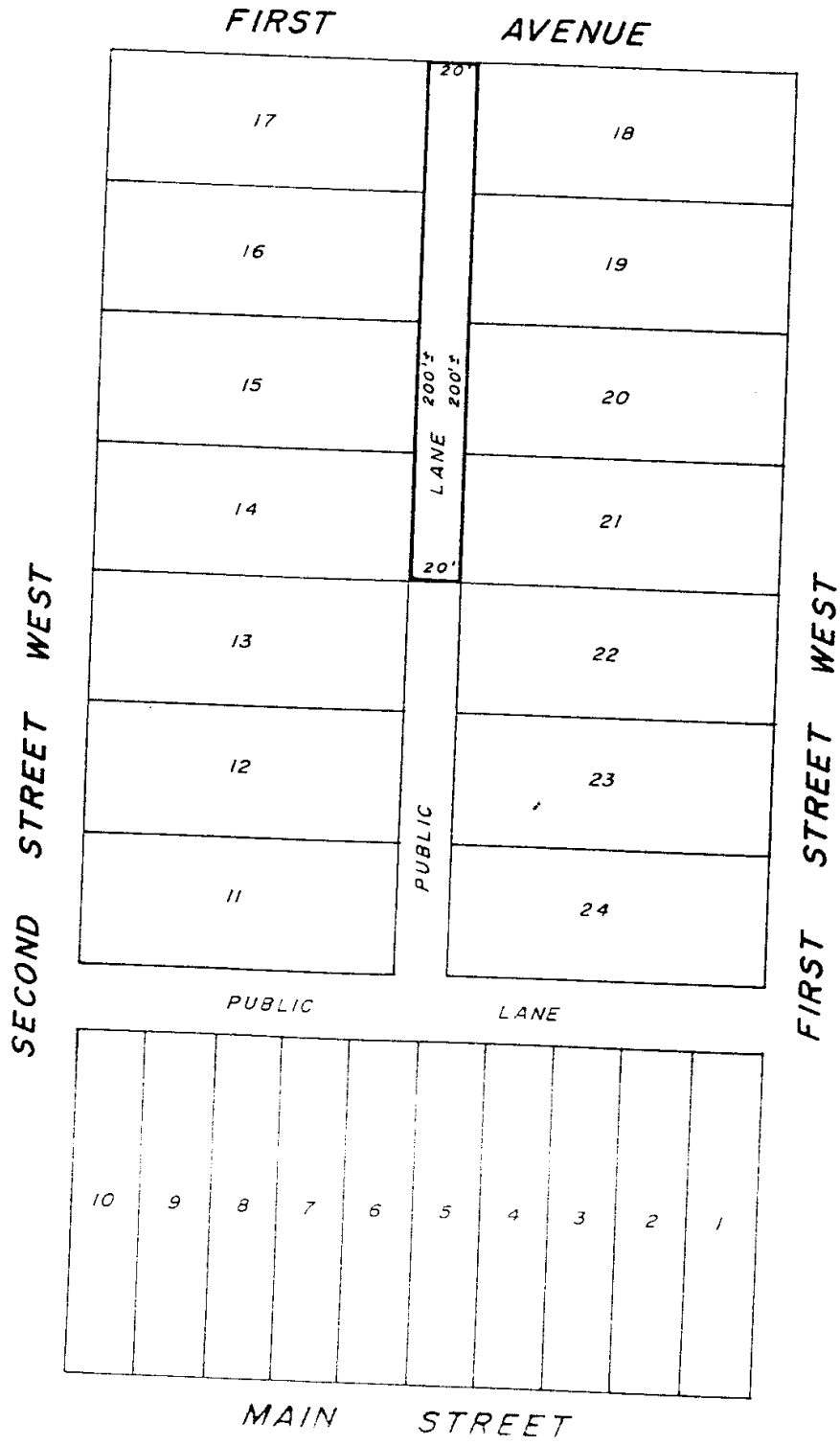

NOTICE OF CLOSING OF PUBLIC LANE

PUBLIC NOTICE is hereby given that the Council of The Rural Municipality of Morris intends to pass a by-law closing all that portion of a Public Lane described as follows:

"All that portion of the South-West Quarter of Section Six in the Fifth Township and First Range, West of the Principal Meridian, in Manitoba, shown as a Public Lane in Block Two, which lies to the North of a straight line drawn from the South-East corner of Lot Fourteen to the South-West corner of Lot Twenty-one in said Block Two, which lots and block are shown on a plan registered in the Morden Land Titles Office as No. 522"

and the sale of the Public Lane so closed, except mines and minerals, to Lowe Farm Housing Crpn. Inc.

A copy of the plan of the Public Lane to be closed is on file at the office of The Rural Municipality of Morris, at Morris, Manitoba, and may be inspected by anyone interested therein upon request. The Council of the Rural Municipality of Morris, will, at its regular meeting to be held at Morris, Manitoba, on June 10, 1982, at 2:00 p.m., hear any person or the agent of any person who claims that his land will be prejudicially affected by the proposed by-law and who applies to be heard at that time and place.

DATED at Morris, Manitoba, this 5th day of May, 1982.

"GRANT G. MacAULAY"
Secretary-Treasurer,
THE RURAL MUNICIPALITY OF MORRIS